

Modellname:  
Nazwa modelu:

**BRIGHT**

Modellreihe:  
Numer modelu:

**37 -- BR**

Type: **11**  
Typ:

Blatt Nr 1 von: 6  
Strona z: 6

# MONTAGEANLEITUNG INSTRUKCJA MONTAŻOWA

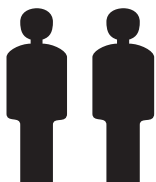

**2 Personen  
2 Osoby**

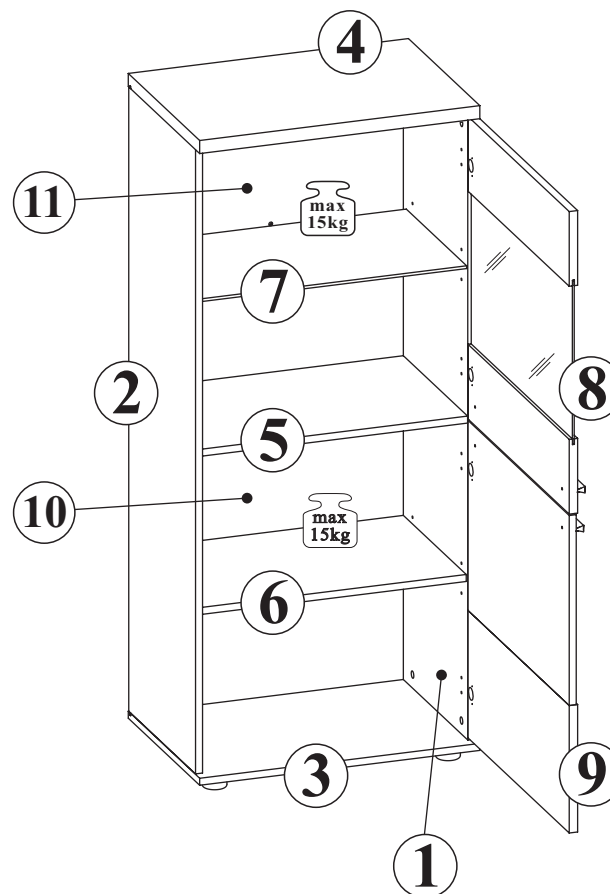
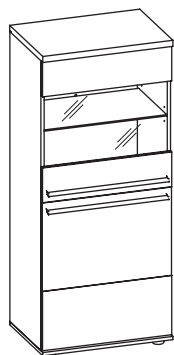
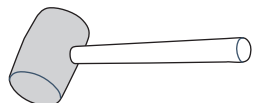
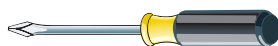
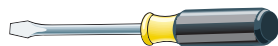
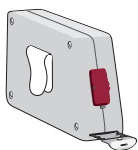

**Pflegehinweis!**

Bitte nur mit einem Staubtuch oder einem feuchten Lappen reinigen. **KEINE** scheuernde Putzmittel verwenden!

**Wskazówka dotycząca pielęgnacji!**

Proszę czyścić tylko suchą lub lekko wilgotną szmatką do kurzu. Nie używać żadnych środków szorstkich!

Max. zulässige Belastungen von Einlegeböden in kg:

Maksymalne obciążenie półek w kg:

Stärke/Gr.	Spanplatte/Płyta			Glas/Szkło
Länge/Dł. mm	15	18	22	5/6
0<400				Länge bis
401<600	40	40	40	600 mm/15kg
601<800	24			Länge bis
801<1000	15	30		900 mm/10kg

**NR 3**

- Y0** Kr0 x4
- Y5** H2 x4
- S8** 4x13 mm x8
- E1** 6,3x13 x8

**NR 5**

- J44** x1
- P13** 3,5x13 x1
- G22** φ18 x2
- T13** φ8 x1
- S15** 4x45 x1

**NR 1**

- B1** φ 8x28 x12
- M1** x12

- T1** x12

- C2** x12

- W2** x8

- P3** 3x18 x4

- F1** x4

- J23** x8

- C3** φ 8 x1

**NR 2**

- U48** x2

- P5** 4x30 x6

**NR 4**

- F10** x4

- P4** 4x25 x4

- L10** x2



**1**

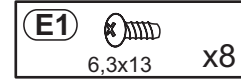
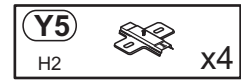
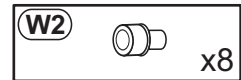
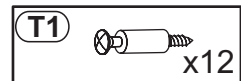
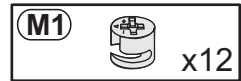
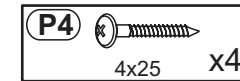
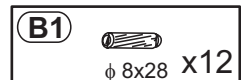
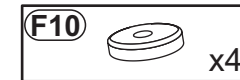
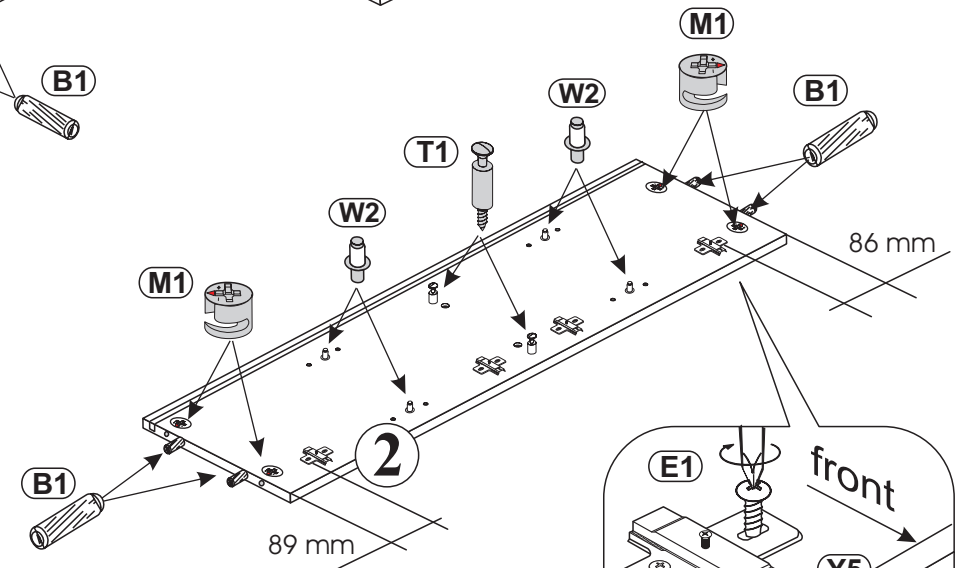
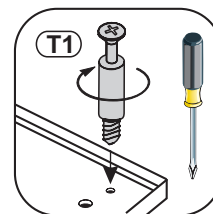
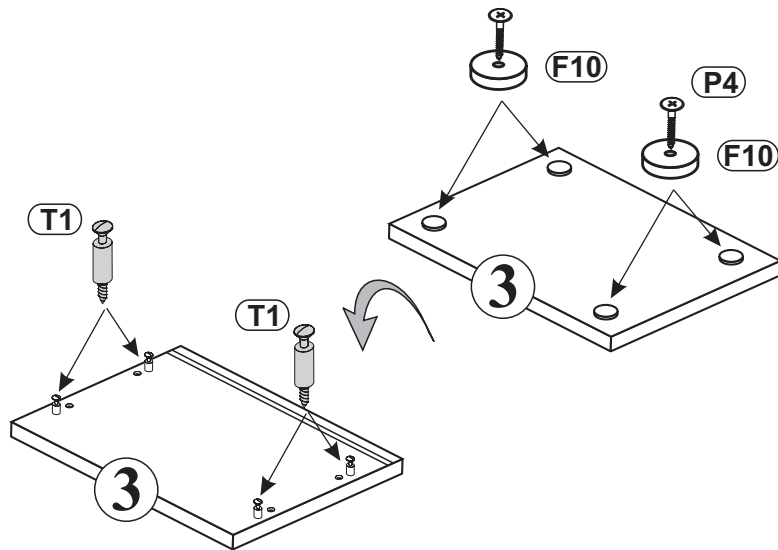
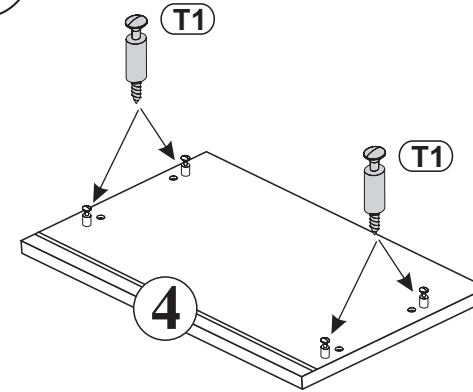
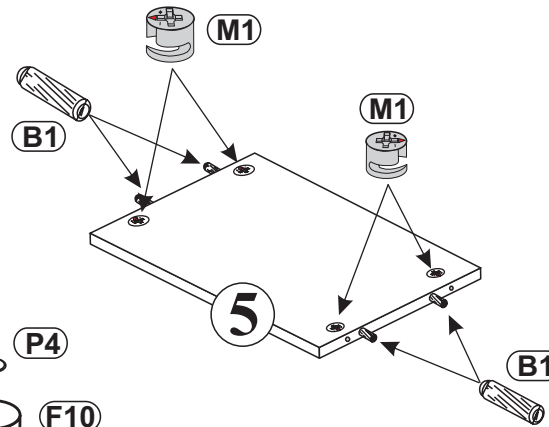
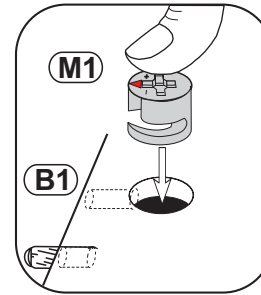
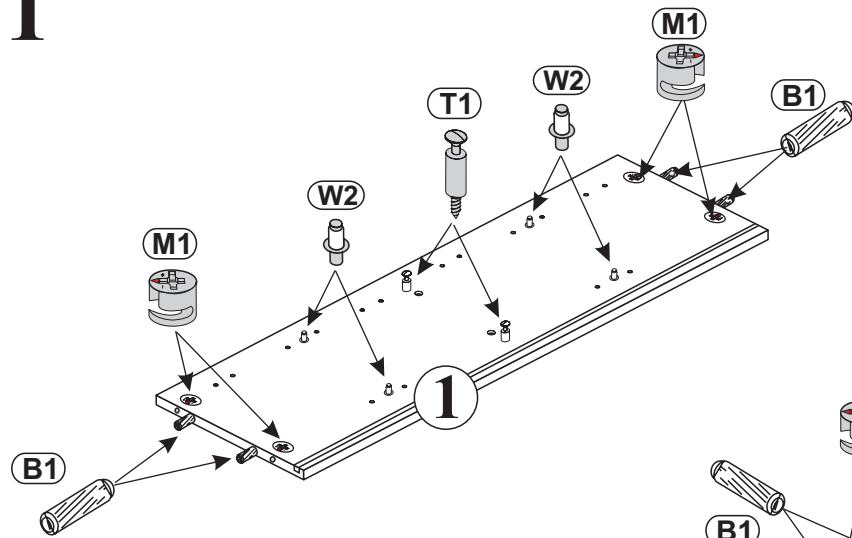

**2**

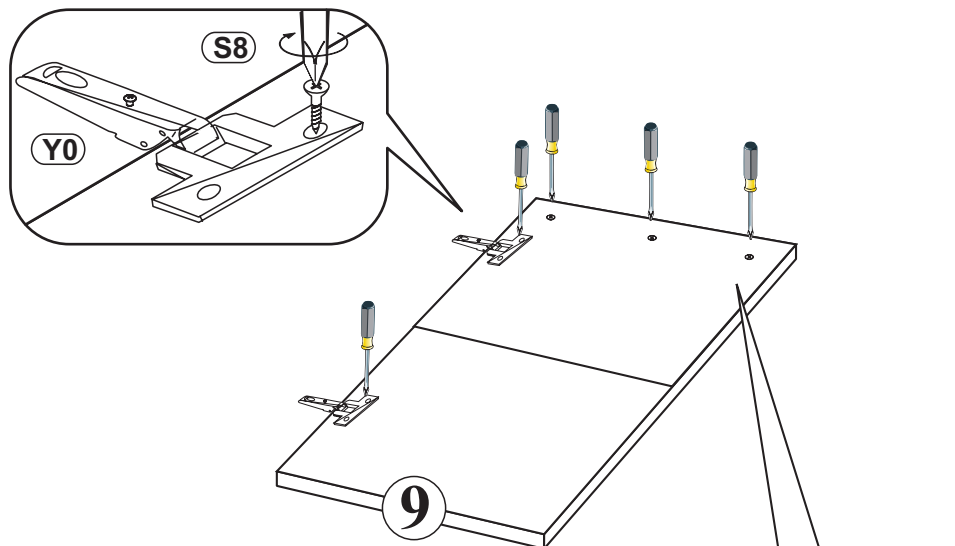
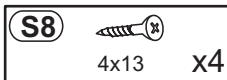
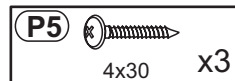
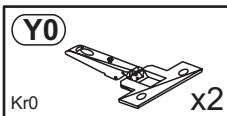
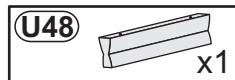

**3**

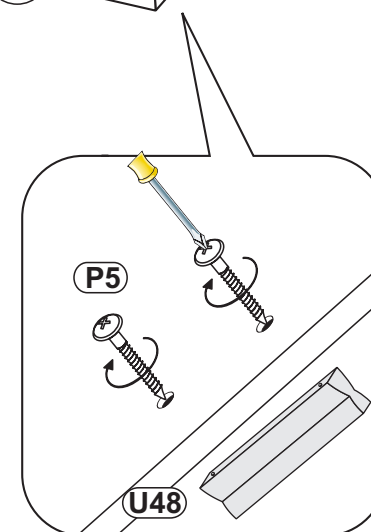
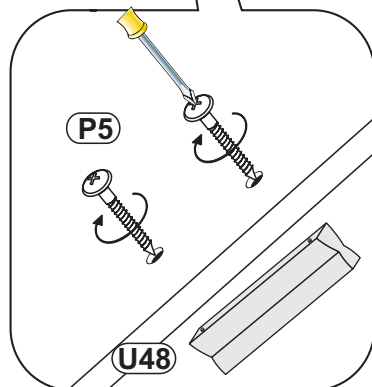
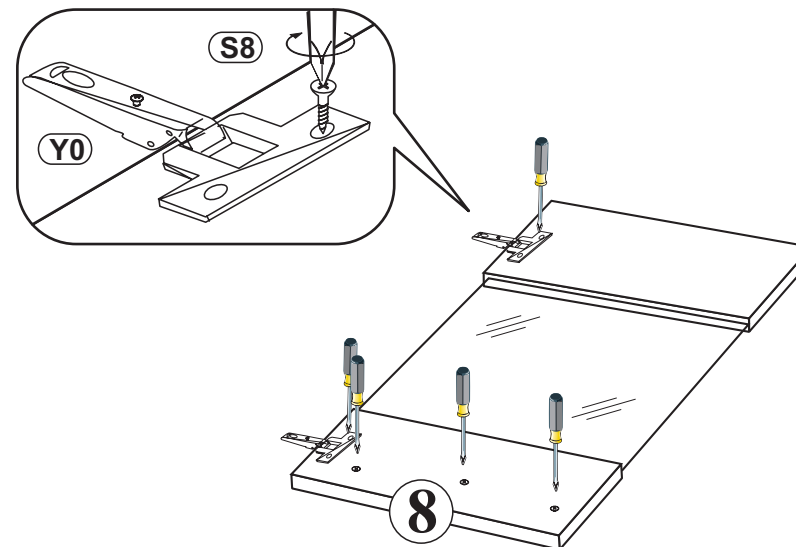
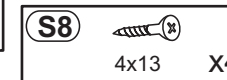
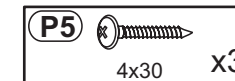
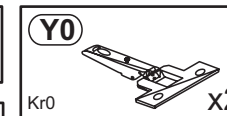
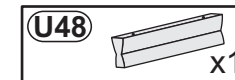

**4**

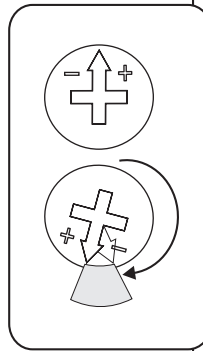
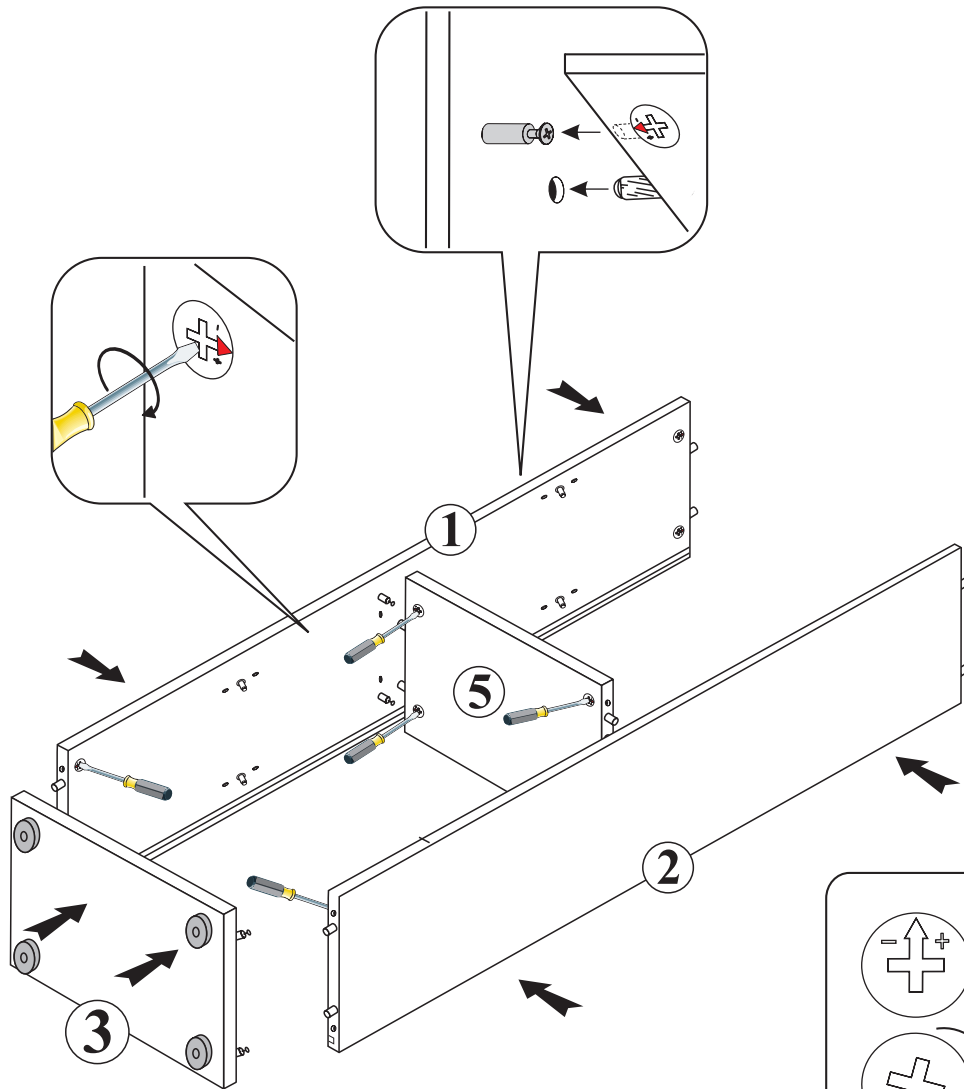

**5**

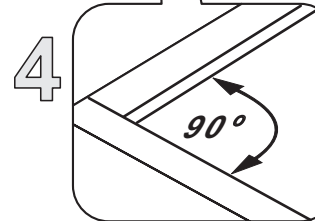
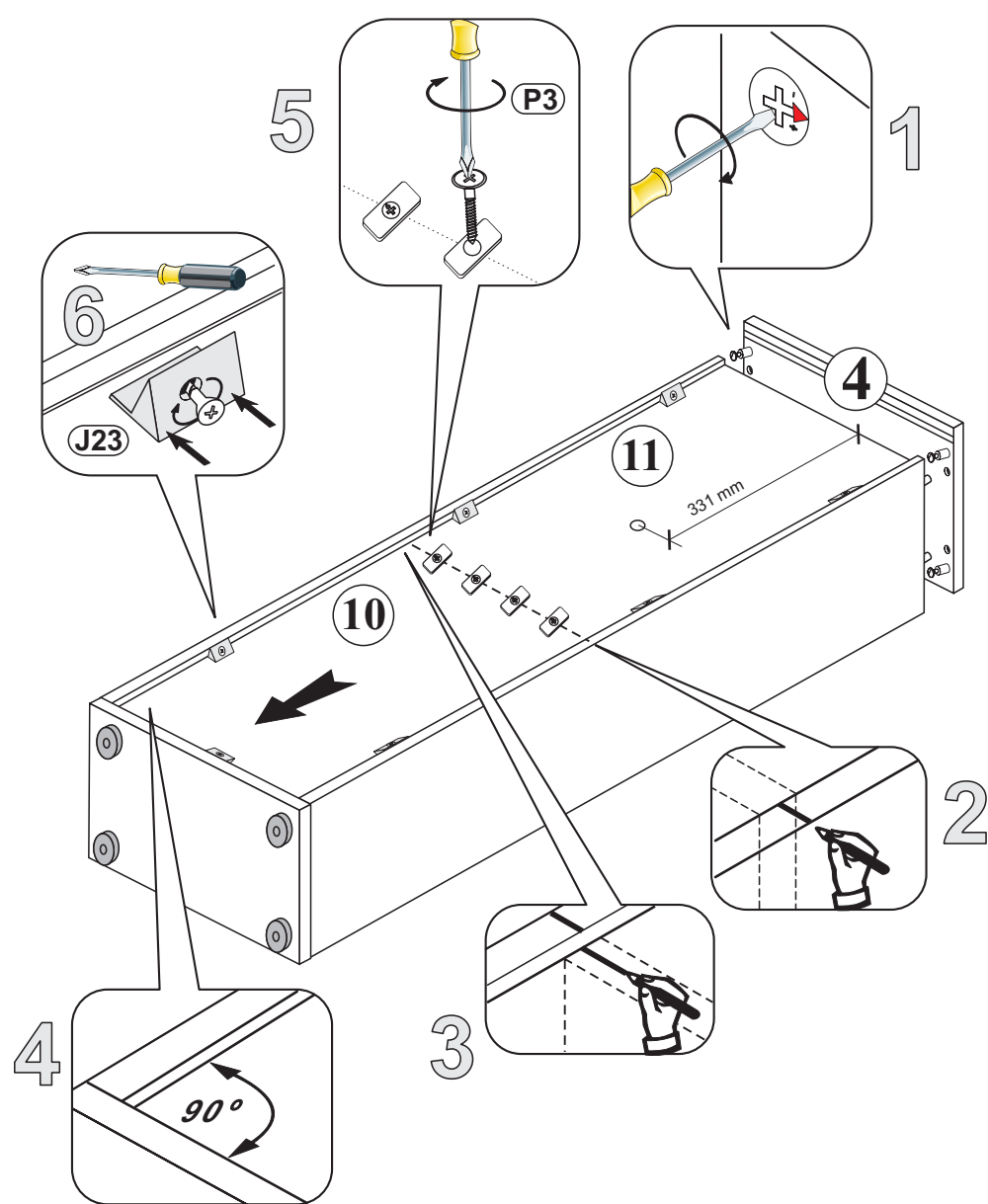
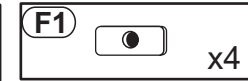
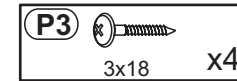

**6**

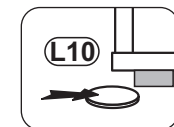
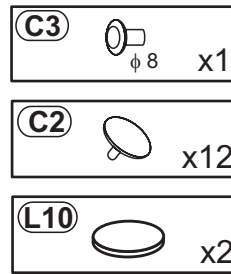
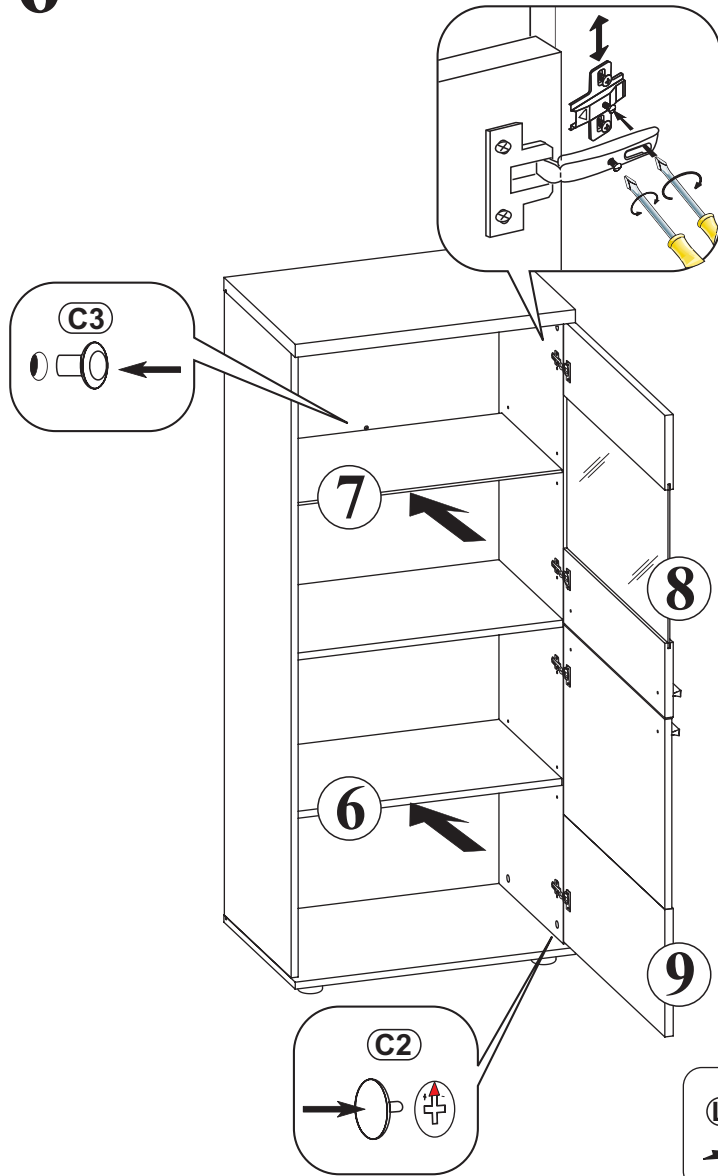

**Achtung !**  
 Bei Bedarf greifen Sie auf  
 das Unterlegmaterial zurück.

**7**

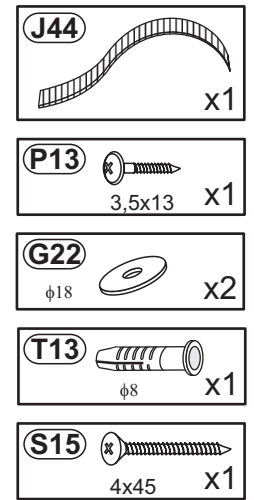
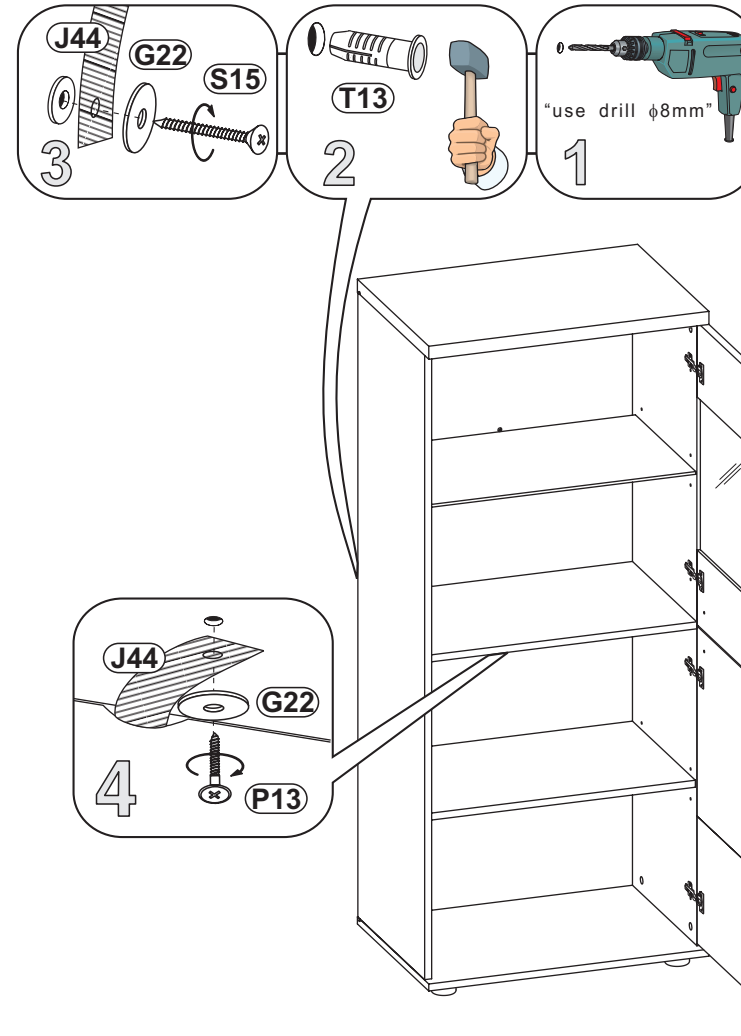

**(PL)** Załączone kołki do zawieszania bryty,  
 do stosowania wyłącznie do ścian betonowych,  
 do innych ścian należy odpowiednie dokupić.

**(GB)** Attached dowels to hang up unit  
 are for concrete walls only. For other types of walls,  
 appropriate dowels must be purchased

**(D)** Die beigefügten Dübel zum Aufhängen des Elements  
 dürfen nur bei Betonwänden eingesetzt werden,  
 bei anderen Wandarten müssen entsprechende  
 Dübel zugekauft werden.

**(F)** Les chevilles jointes, pour pendre l'élément,  
 sont pour les murs bétonnés exclusivement;  
 pour autres murs il faut acheter chevilles adéquates

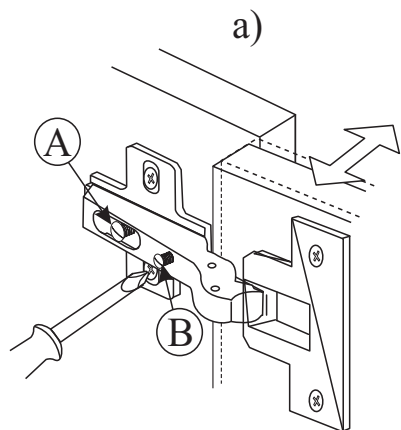

## *Verstellmöglichkeiten*

### **a) Fugenverstellung:**

Befestigungsschraube "A" lockern, gewünschte Fuge mit Schraube "B" einstellen, Schraube "A" anziehen.

### **b) Tiefenverstellung:**

Befestigungsschraube "A" lockern, Bandarm nach vorne oder rückwärts verschieben, Schraube "A" anziehen, Schraube "B" mit einer 1/4 Drehung nach rechts arretieren.

### **c) Höhenverstellung:**

Befestigungsschraube "C" lockern, Höhe einstellen, Schraube "C" anziehen.

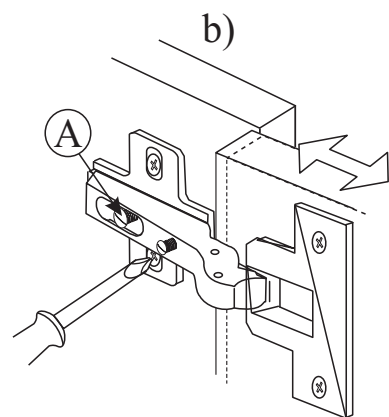

## *Instructions for hinge adjustment*

### **a) Side adjustment:**

Loosen fixing screw "A", adjust gap with screw "B" and retighten screw "A".

### **b) Depth adjustment:**

Loosen fixing screw "A", push hinge arm forwards or backwards, re-tighten screw "A", fix screw "B" with a 1/4-tur in clock-wise direction.

### **c) Height adjustment:**

Loosen screw "C", adjust height, re-tighten screw "C".

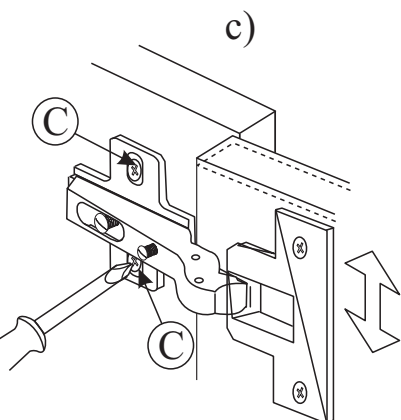

## *Les possibilités de positionnement*

### **a) Positionnement de la rainure:**

Desserrer la vis de fixation "A", positionner avec la vis "B" la rainure (joint) souhaitée et resserrer la vis "A".

### **b) Positionnement de la profondeur:**

Desserrer la vis de fixation "A" (1 tour), régler la profondeur et resserrer la vis "A".

### **c) Positionnement de la hauteur:**

Desserrer la vis de fixation "C" (1 tour), positionner la hauteur et resserrer la vis "C".

## *Możliwości regulacji*

### **a) Regulacja szczeliny:**

Poluzować wkręt "A", wkrętem "B" ustawić odpowiednią szczelinę, dokręcić wkręt "A".

### **b) Regulacja głębokości:**

Poluzować wkręt "A" (1 obrót), ustawić głębokość, dokręcić wkręt "A"

### **c) Regulacja wysokości:**

Poluzować wkręt "C" (1 obrót), dokonać regulacji wysokości położenia drzwi, wkręt "C" dokręcić.