

Modellname:
Nazwa modelu:

AQUA

Modellreihe:
Numer modelu:

P6--C8

Type:
Typ:

04

Blatt Nr **1** von: **6**
Strona z:

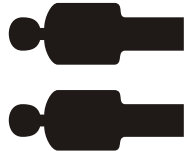
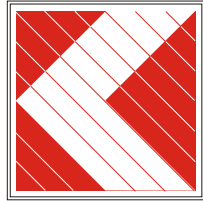

2 Personen
2 Osoby

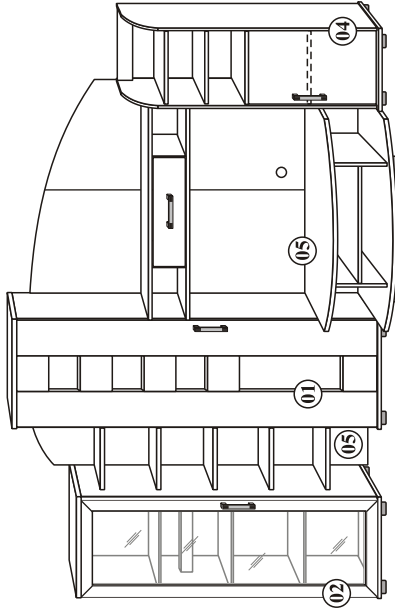
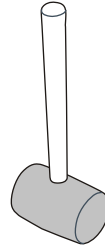
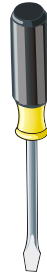
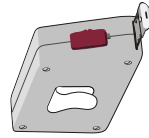

MONTAGEANLEITUNG INSTRUKCJA MONTAŻOWA

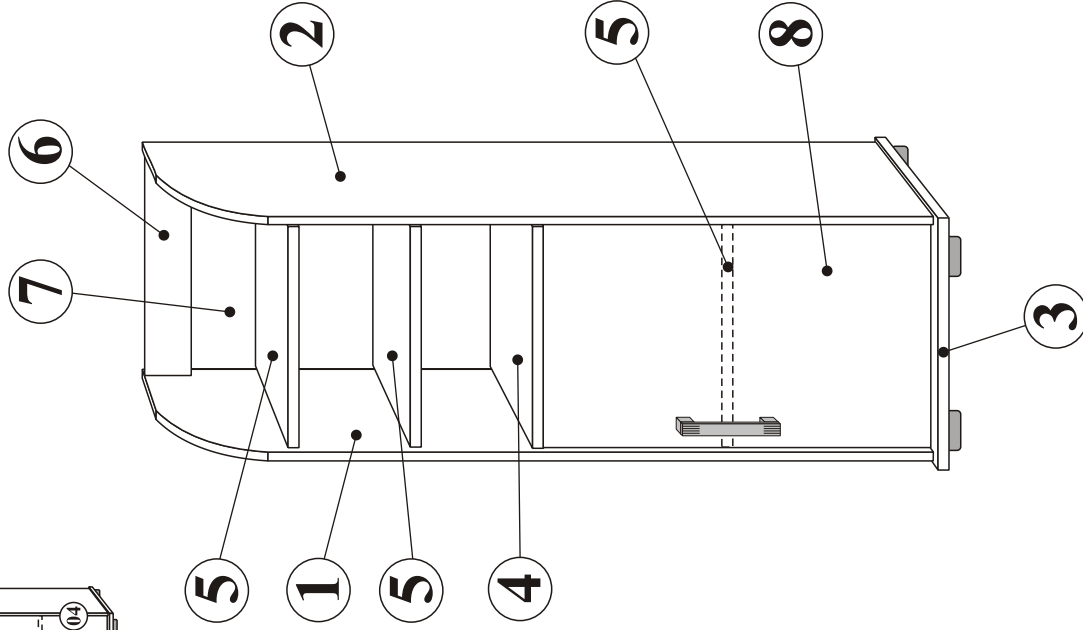

Pflegehinweis!

Bitte nur mit einem Staubbuch oder einem feuchten Lappen reinigen.
KEINE scheuernde Putzmittel verwenden !

Wskazówka dotycząca pielęgnacji!

Proszę czyścić tylko suchą lub lekko wilgotną szmatką do kurzu.
Nie używać żadnych środków szorstkich !

Max. zulässige Belastungen von Einlegeböden in kg:

Maksymalne obciążenie półek w kg:

Stärke/Gr. Länge/Dł. mm	Spanplatte/Płyta		
0<400	15	18	22
401<600	40	40	40
601<800	24		
801<1000	15	30	

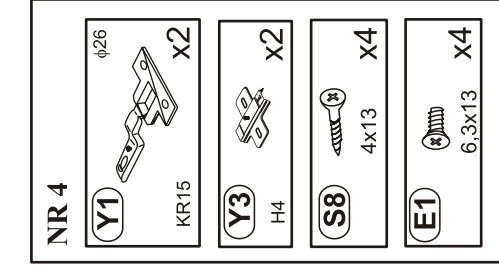
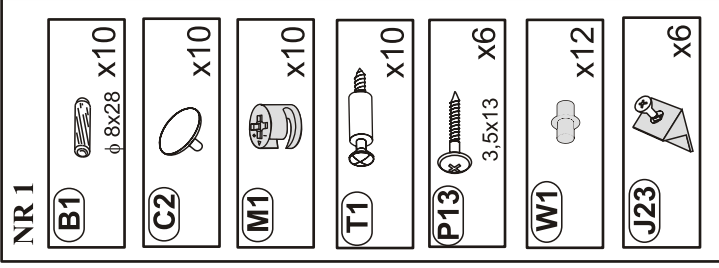

Modellname: **AQUA**
Nazwa modelu:

Modellreihe: **P6--C8**
Numer modelu:

Type: **04**
Typ:

Blatt Nr **2** von: **6**
Strona z:

1

Y3 H4	x2	B1 φ 8x28	x10
E1 6,3x13	x4	M1	x10
		T1	x10
		W1	x12

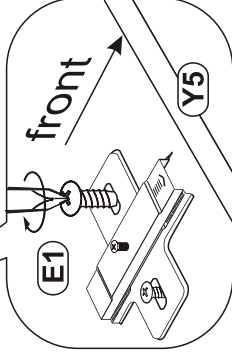
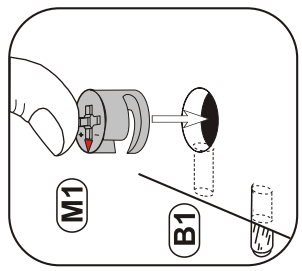
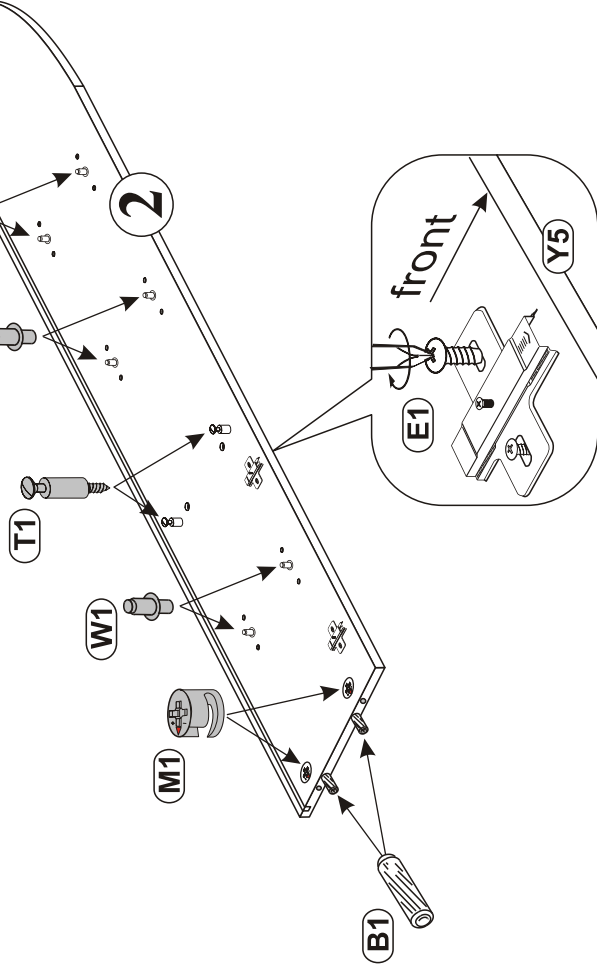
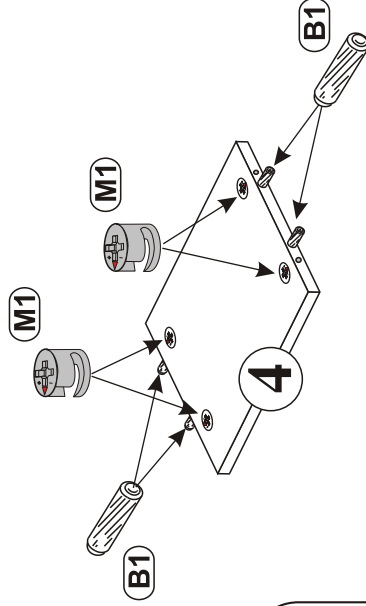
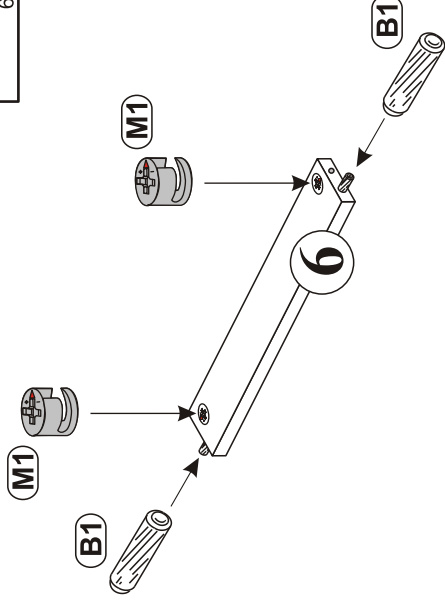
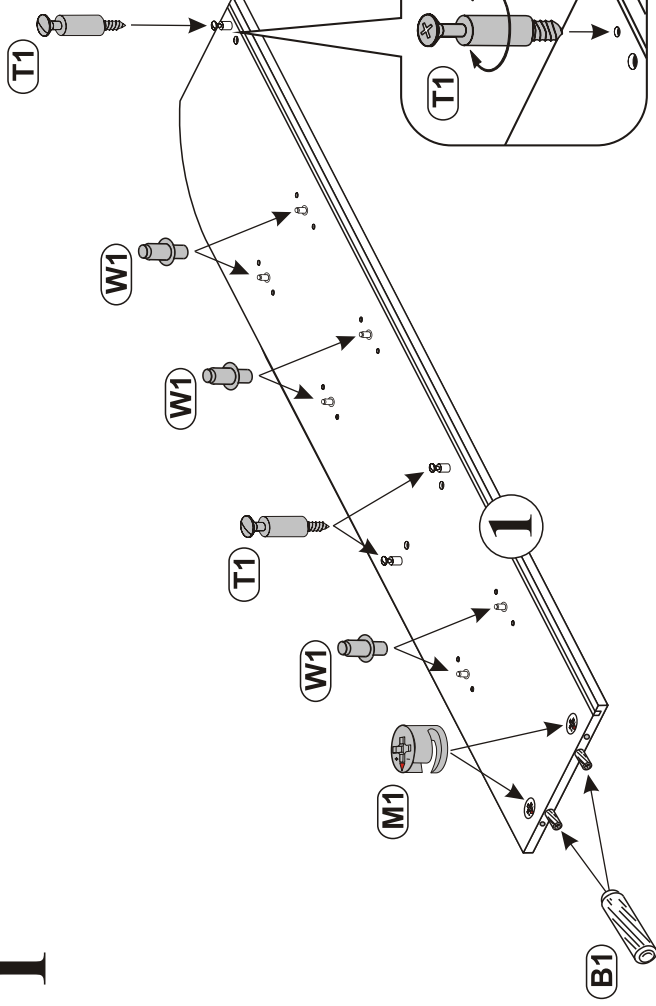

Modellname: **AQUA**
Nazwa modelu:

Modellreihe:
Numer modelu:

P6--C8

Type: **04**
Typ:

Blatt Nr **3** von: **6**
Strona z:

2

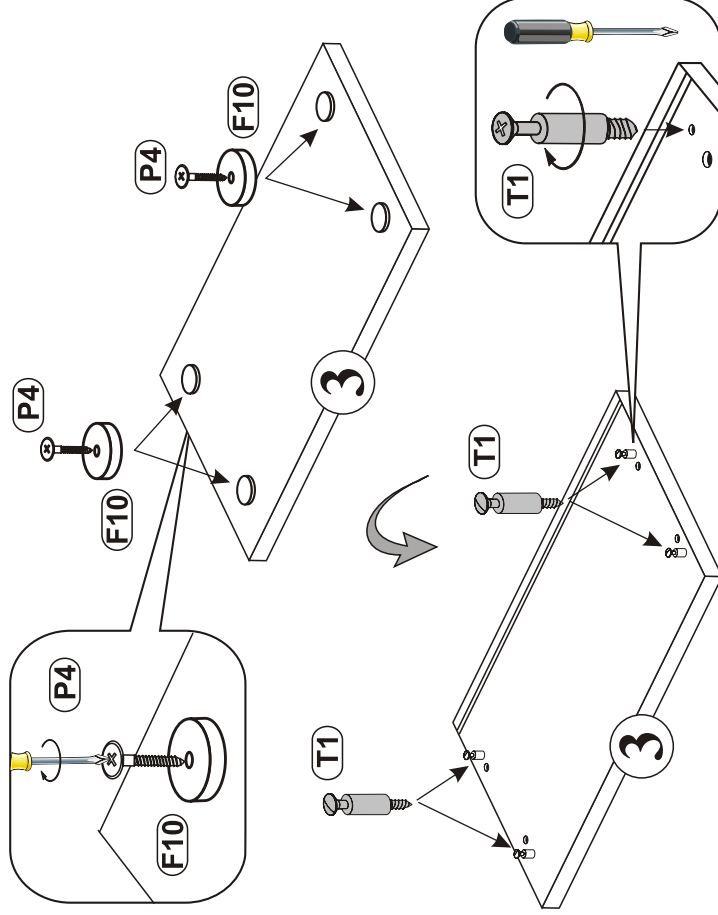
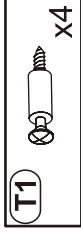
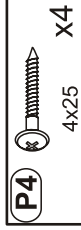
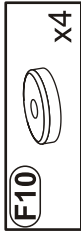

3

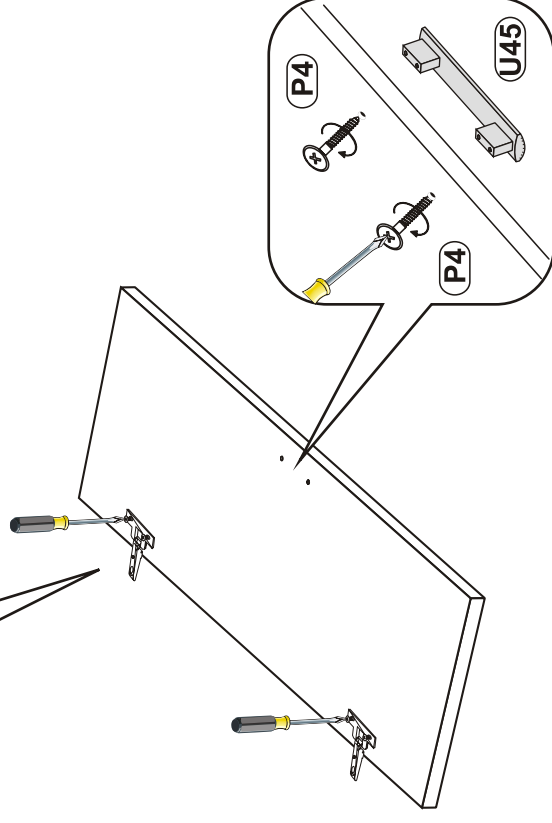
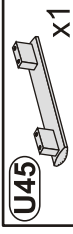
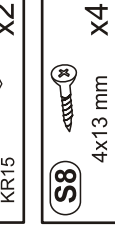
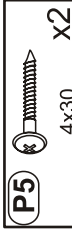
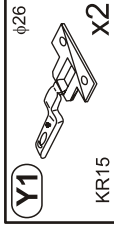
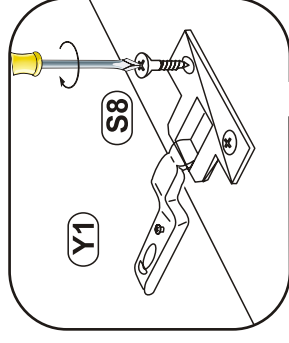

Modellname: **AQUA**
Nazwa modelu:

Modellreihe: **P6--C8**
Numer modelu:

Type: **04**
Typ:

Blatt Nr **4** von: **6**
Strona z:

4

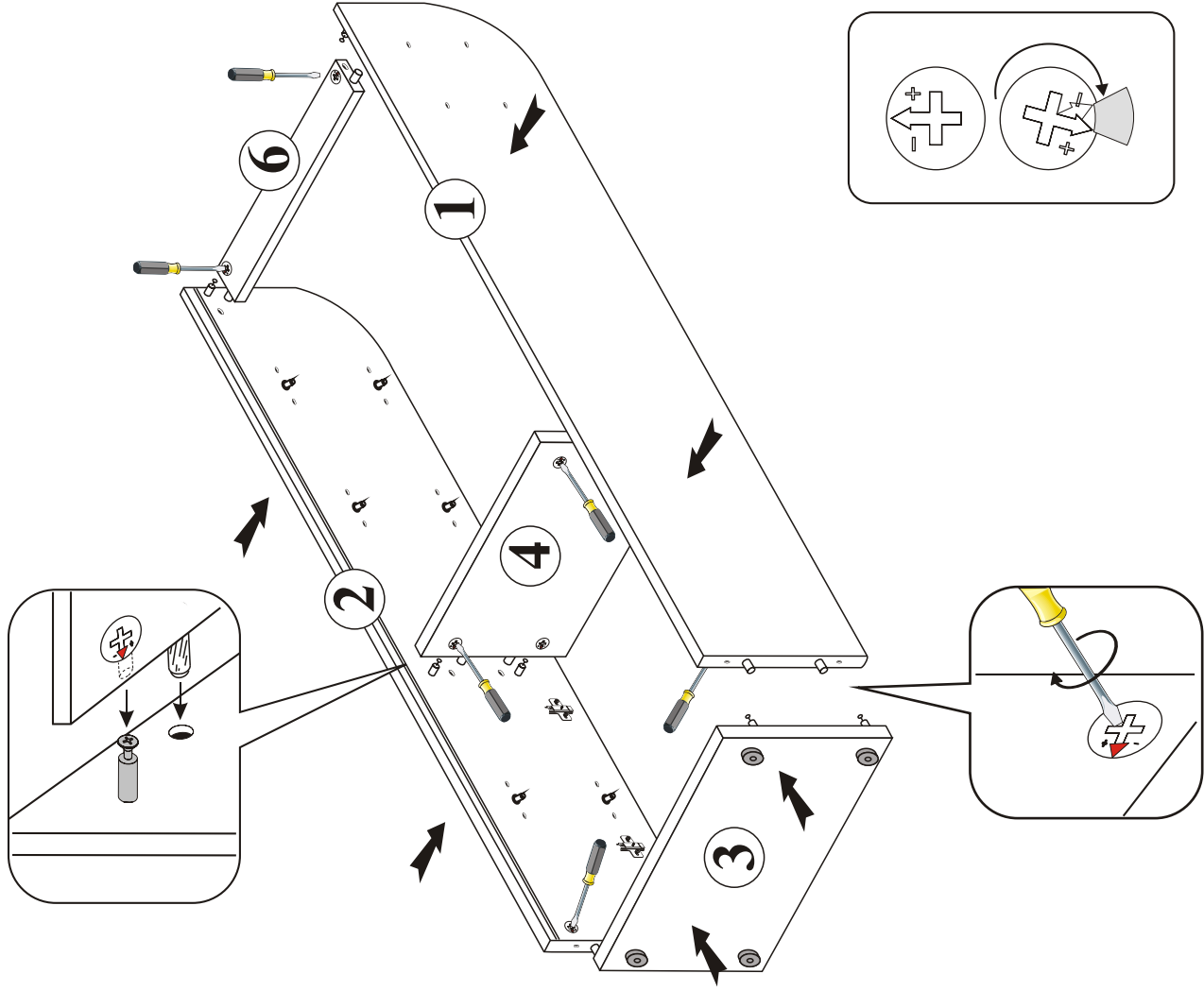

5

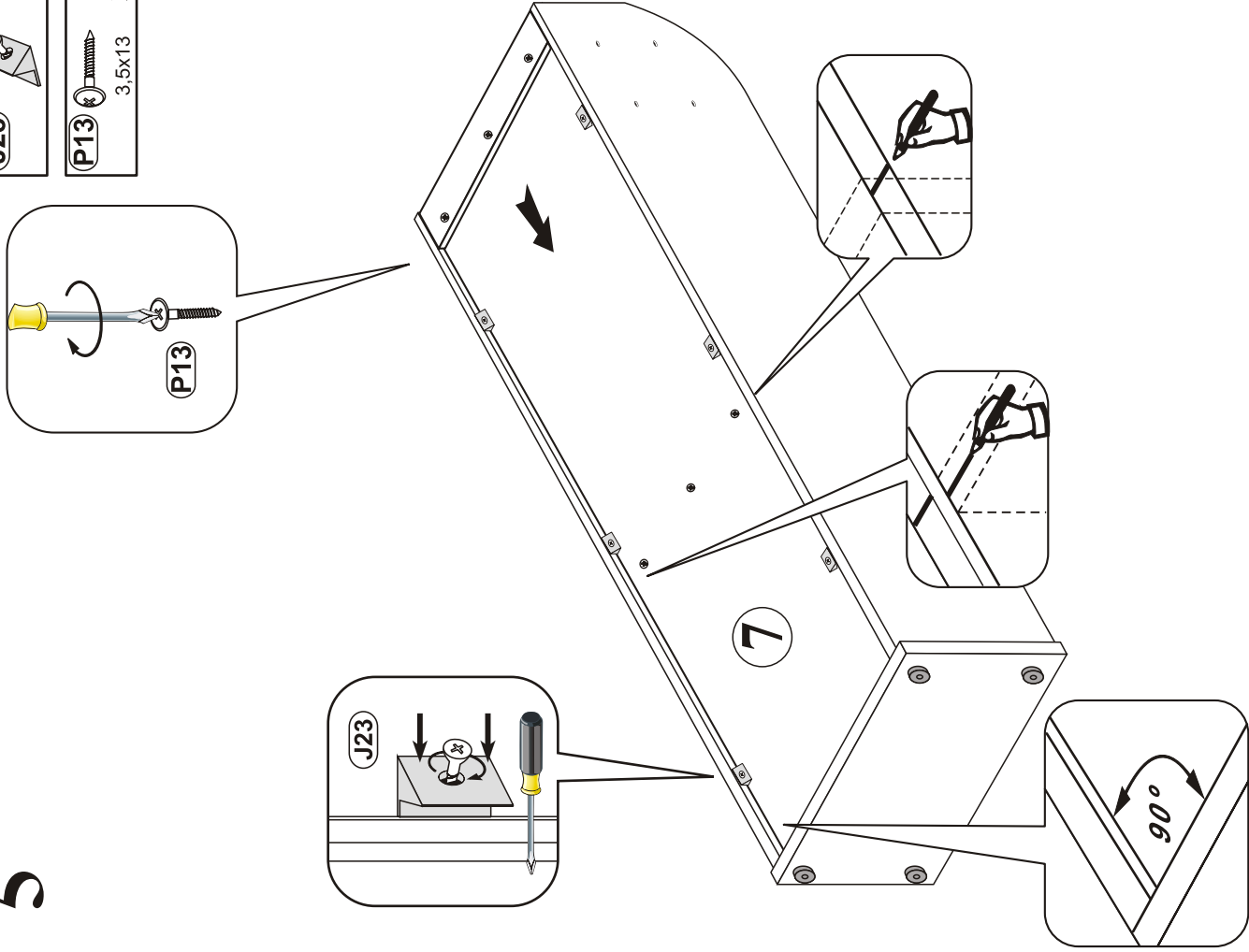

- J23** x6
- P13** 3,5x13 x6

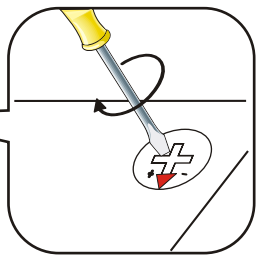
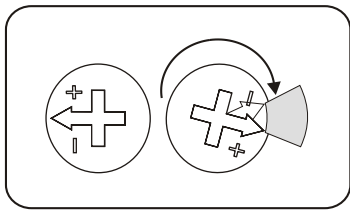
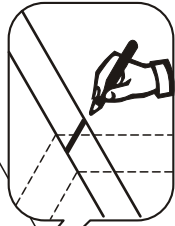
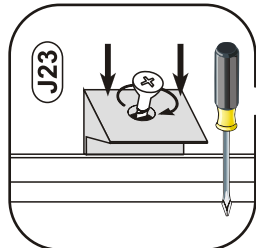
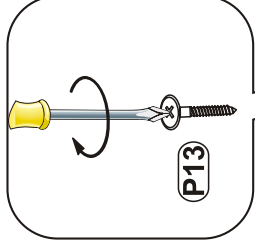

Modellname: **AQUA**
Nazwa modelu:

Modellreihe: **P6--C8**
Numer modelu:

Type: **04**
Typ:

Blatt Nr **5** von: **6**
Strona z:

6

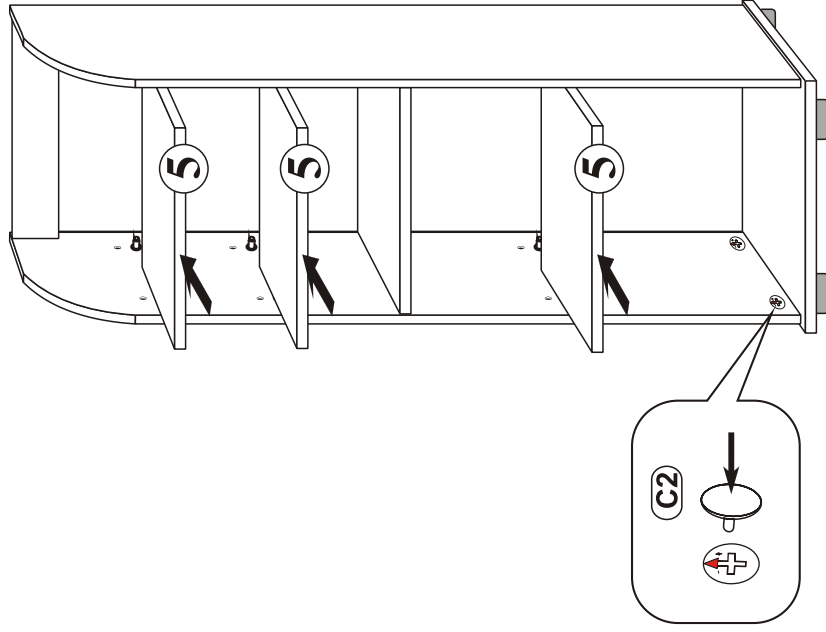
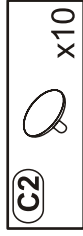

7

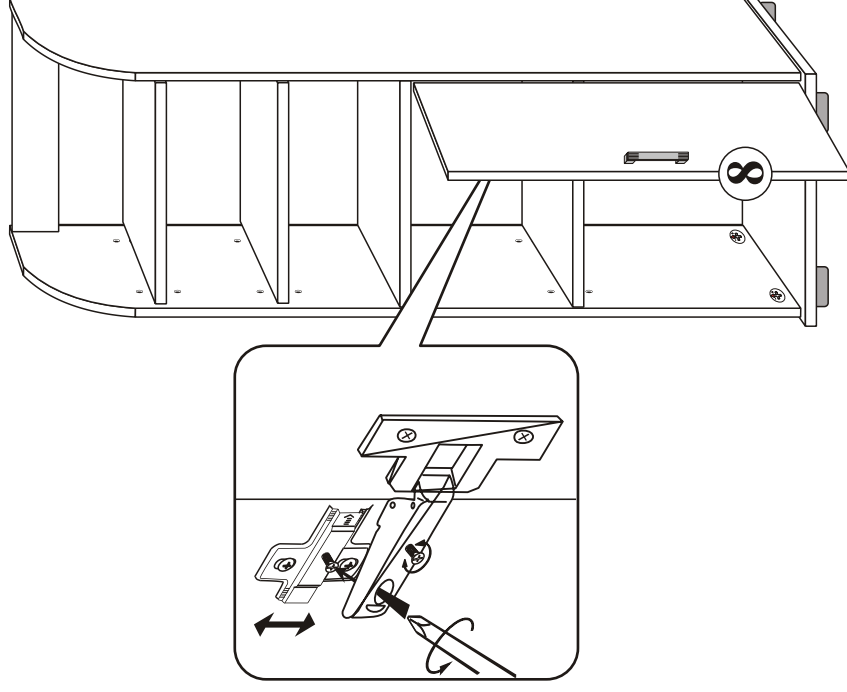

a)

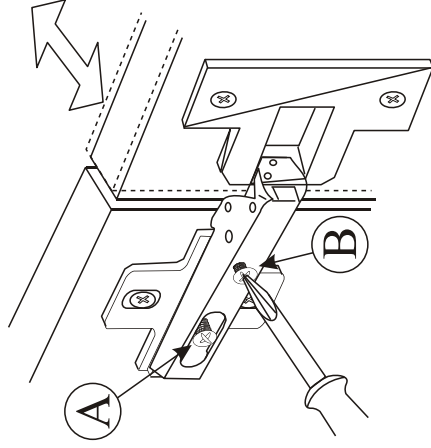

Verstellmöglichkeiten

- Fugenverstellung:
Befestigungsschraube "A" lockern, gewünschte Fuge mit Schraube "B" einstellen, Schraube "A" anziehen.
- Tiefenverstellung:
Befestigungsschraube "A" lockern, Bandarm nach vorne oder rückwärts verschieben, Schraube "A" anziehen, Schraube "B" mit einer 1/4 Drehung nach rechts arretieren.
- Höhenverstellung:
Befestigungsschraube "C" lockern, Höhe einstellen, Schraube "C" anziehen.

b)

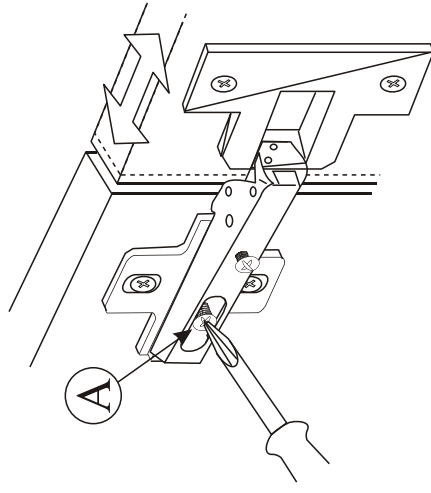

Les possibilités de positionnement

- Positionnement de la rainure:
Desserrer la vis de fixation "A", positionner avec la vis "B" la rainure (joint) souhaitée et resserrer la vis "A".
- Positionnement de la profondeur:
Desserrer la vis de fixation "A" (1 tour), régler la profondeur et resserrer la vis "A".
- Positionnement de la hauteur:
Desserrer la vis de fixation "C" (1 tour), positionner la hauteur et resserrer la vis "C".

c)

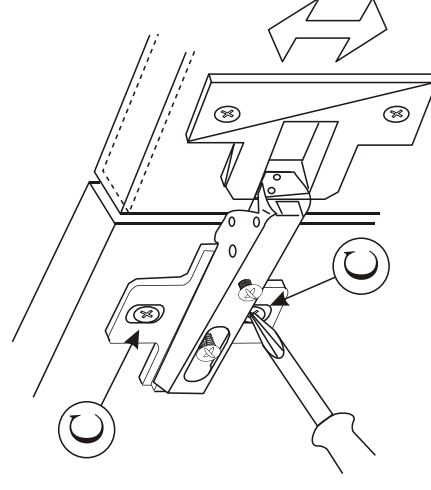

Instructions for hinge adjustment

- Side adjustment:
Loosen fixing screw "A", adjust gap with screw "B" and retighten screw "A".
- Depth adjustment:
Loosen fixing screw "A", push hinge arm forwards or backwards, retighten screw "A", fix screw "B" with a 1/4-turn in clock-wise direction.
- Height adjustment:
Loosen screw "C", adjust height, retighten screw "C".

Możliwości regulacji

- Regulacja szczeliny:
Poluzować wkręt "A", wkrętem "B" ustawić odpowiednią szczelinę, dokręcić wkręt "A".
- Regulacja głębokości:
Poluzować wkręt "A" (1 obrót), ustawić głębokość, dokręcić wkręt "A".
- Regulacja wysokości:
Poluzować wkręt "C" (1 obrót), dokonać regulacji wysokości położenia drzwi, wkręt "C" dokręcić.

SERVICEKARTE

Modellname:
AQUA

Modellnummer:
P6ZCC8

Type:
04



Information zur Reklamationsbearbeitung:

Geben Sie bitte bei Reklamationen Modellnummer, Type sowie die Ersatzteilnummer der benötigten Bauteile an. Ebenfalls müssen Sie Ihre Auftragsnummer angeben.

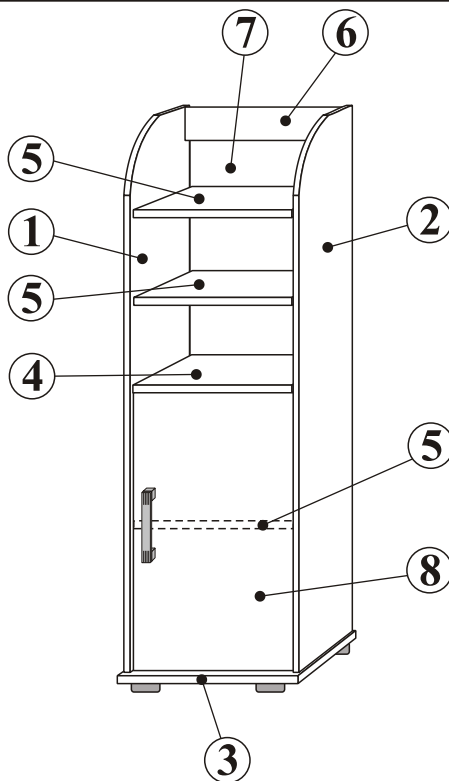

Unser Direkt - Bestellservice für Kleinteile:











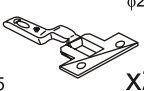

Sollte Ihnen ein Kleinteil fehlen, dann können Sie diese Servicekarte auch direkt an uns faxen unter der Nummer:

Binnen 24 Stunden nach Erhalt ist das Fehlteil dann an Sie unterwegs.
Wir können allerdings nur Kleinteile auf diesem Wege verschicken.

Fax-Nr.: 05282-14547

Sollten Sie eine andere Beanstandung an Ihrem Möbelstück haben, wenden Sie sich bitte an Ihr Möbelhaus.

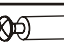
Das defekte oder fehlende Kleinteil können Sie hier auf der Servicekarte eintragen.
Bitte geben Sie auch die Stückzahl der Fehlmenge an.

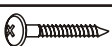
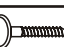
B1  φ 8x28 x10	W1  x12	Y1  φ26 KR15 x2	U45  x1
C2  x10	J23  x6	Y3  H4 x2	P4  4x25 x2
M1  x10		S8  4x13 x4	F10  x4
T1  x10		E1  6,3x13 x4	P4  4x25 x4
P13  3,5x13 x6			

Grund der Beanstandung:.....

Name:..... Telefon:..... Kunden Nr.:..... Kommissions-AB.-Nr.:.....

PLZ:..... Ort:..... Strasse:..... Haus-Nr.:.....



DIE KARTE GILT NUR IN DEUTSCHLAND.
THIS CARD IS VALID ONLY FOR GERMANY.
KARTA DOTYCZY KLIENTÓW NA TERENIE NIEMIEC.