

Modellname:
Nazwa modelu:

DOVER

Modellreihe:
Numer modelu:

SL -- 08

Type: **20**
Typ:

Blatt Nr **1** von: **5**
Strona z:

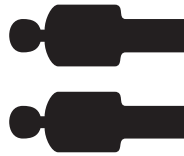

2 Personen
2 Osoby

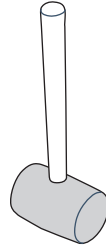
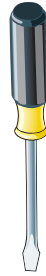
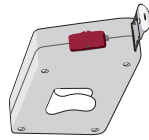

MONTAGEANLEITUNG INSTRUKCJA MONTAŻOWA

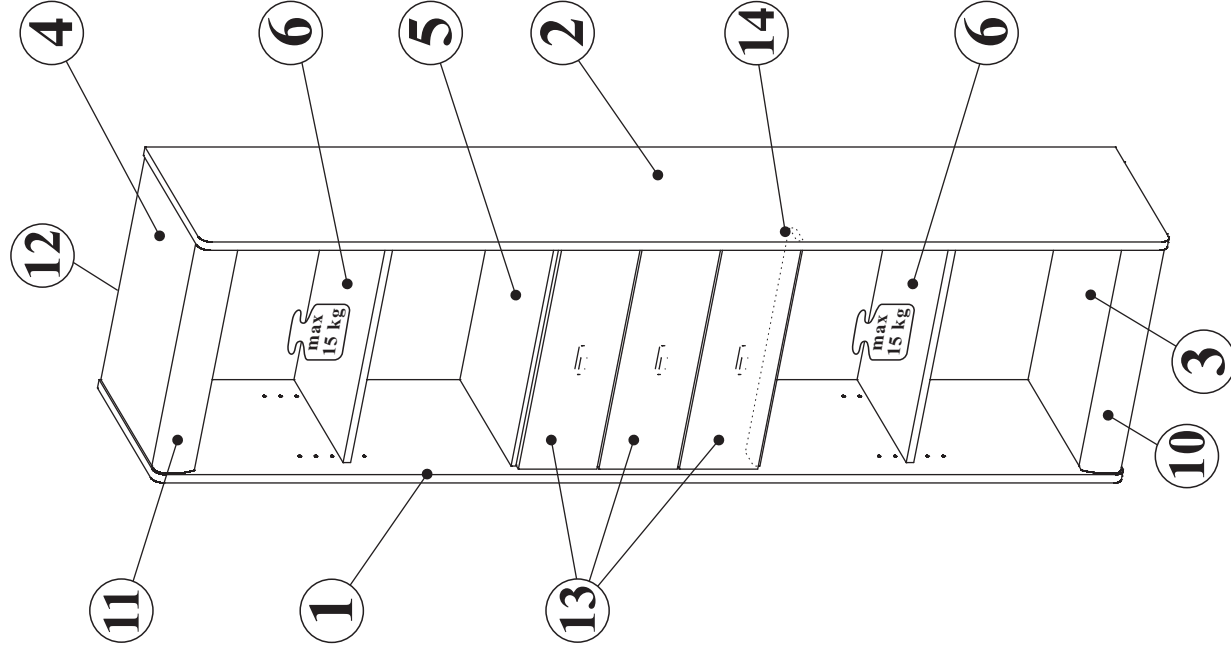

MONTAŻ NA ROZŁOŻONYM KARTONIE!

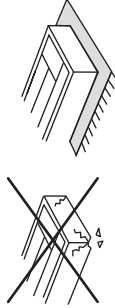

Wskazówka dotycząca pielęgnacji!

Proszę czyścić tylko suchą lub lekko wilgotną szmatką do kurzu.
Nie używać żadnych środków szorstkich!
Maksymalne obciążenie półek w kg:

Stärke/Gr.	Spanplatte/Plyta
Länge/Dł. mm	15 18 22
0 < 400	
401 < 600	40 40 40
601 < 800	24
801 < 1000	15 30

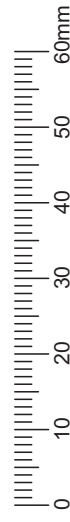
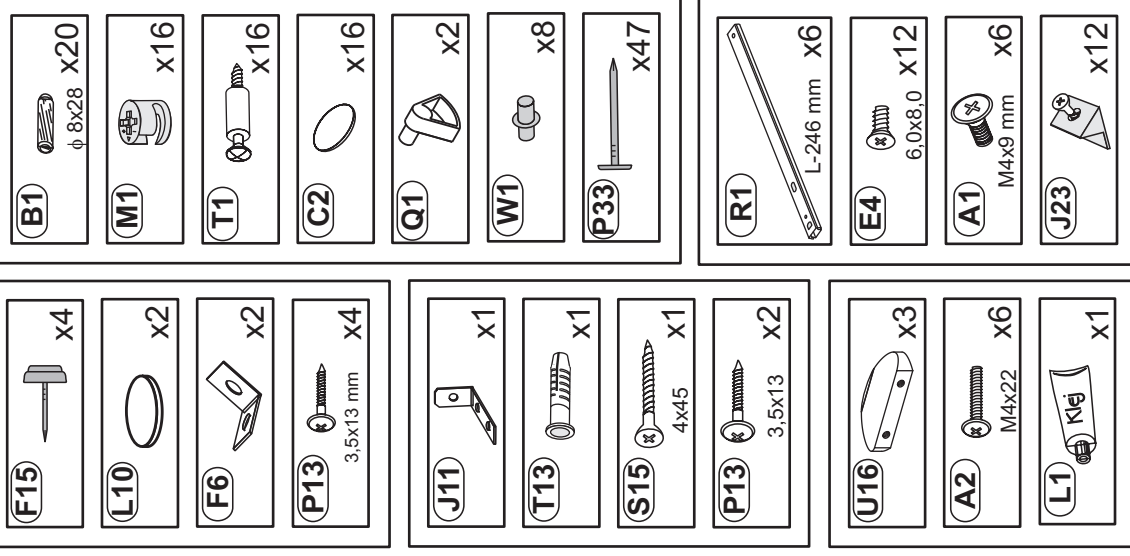
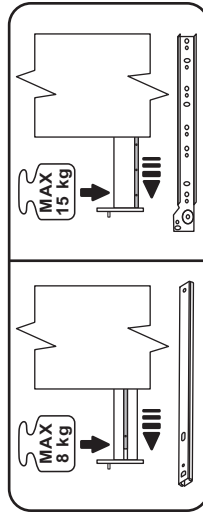

Modellname:
Nazwa modelu:

DOVER

Modellreihe:
Numer modelu:

SL -- 08

Type: **20**
Typ:

Blatt Nr
Strona

von: **5**
z:

1

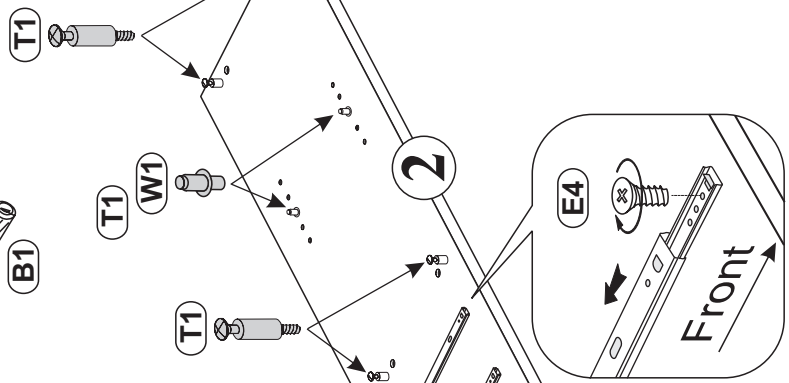
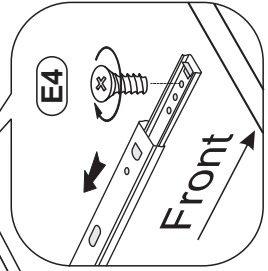
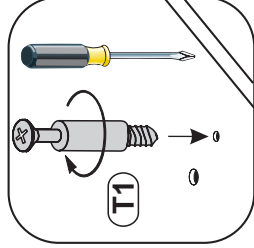
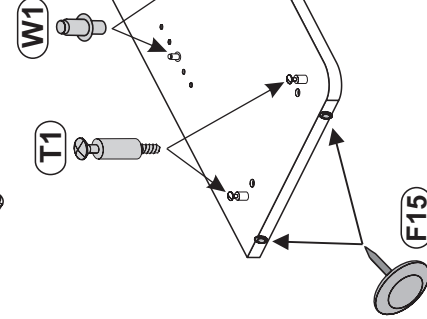
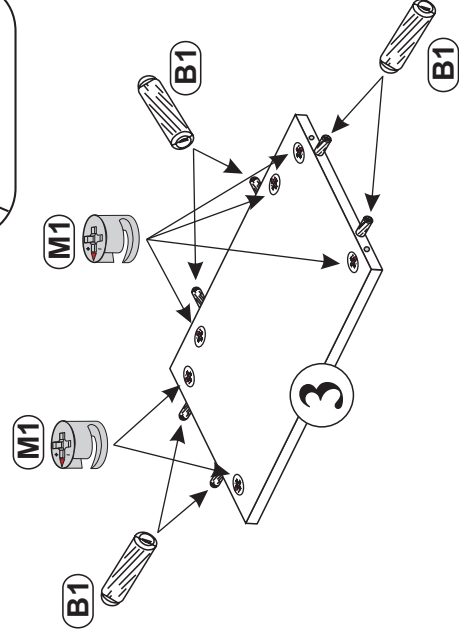
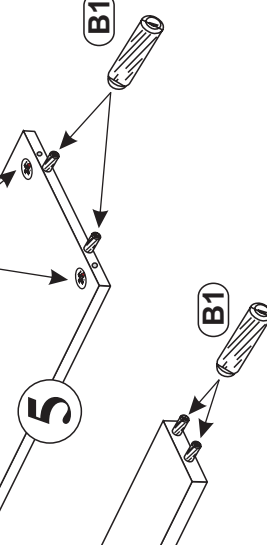
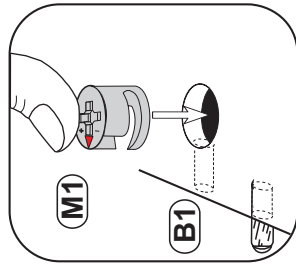
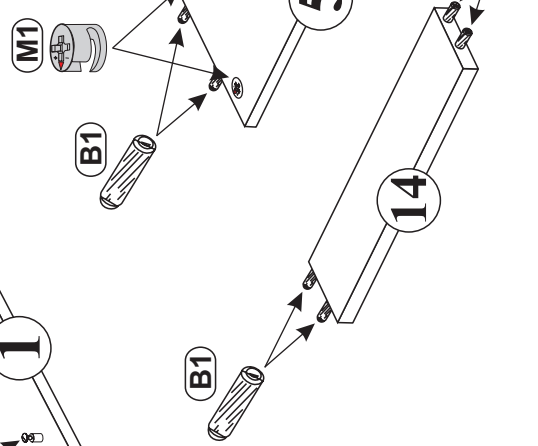
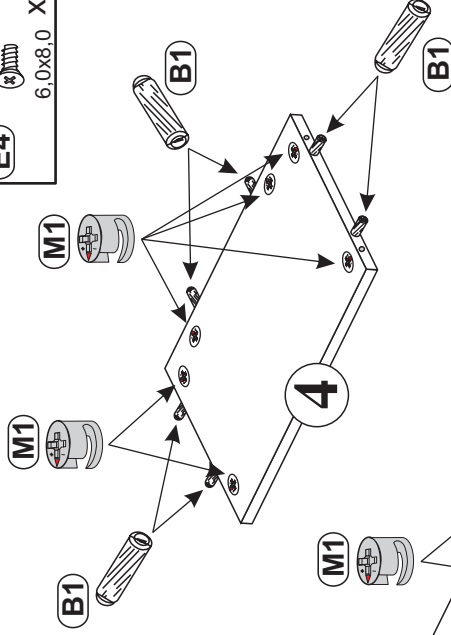
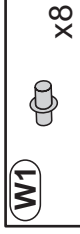
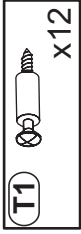
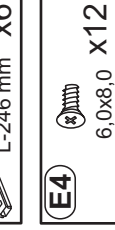
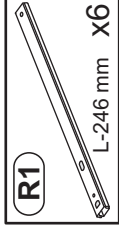
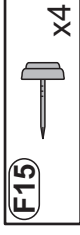
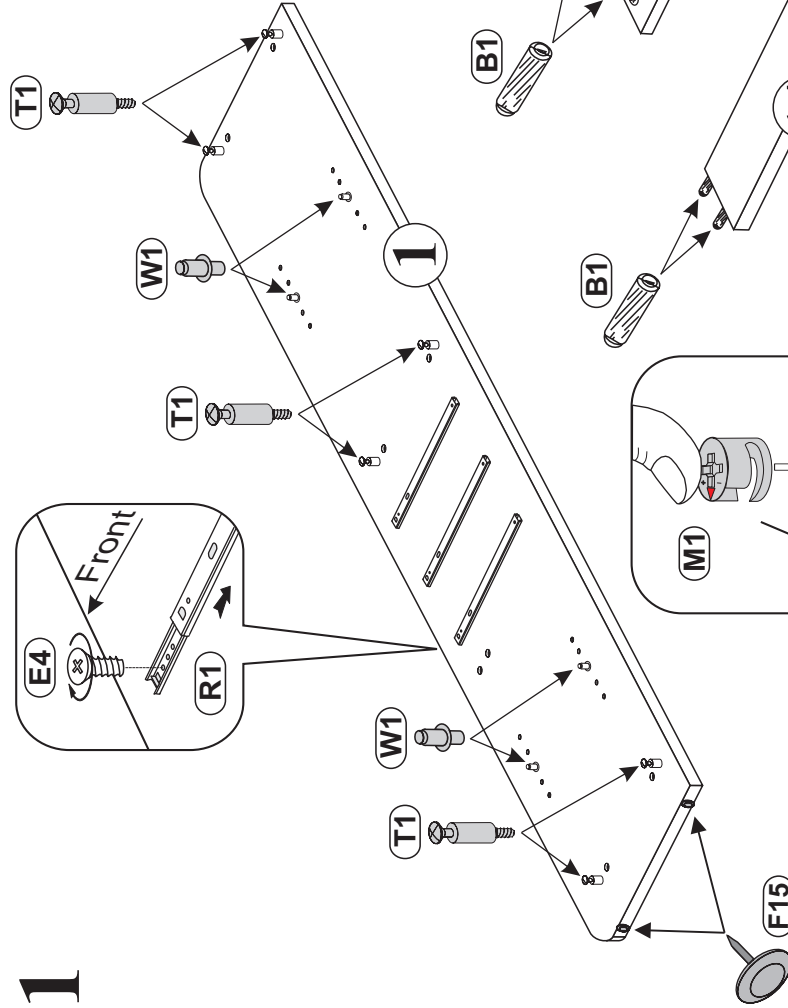
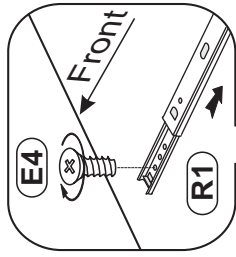

Modelname:
Nazwa modelu:

DOVER

Modellreihe:
Numer modelu:

SL -- 08

Type: **20**
Typ:

Blatt Nr **3** von: **5**
Strona z:

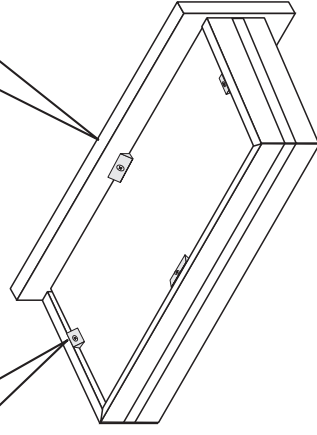
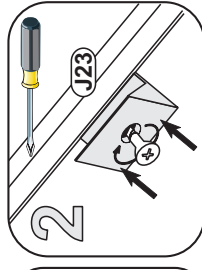
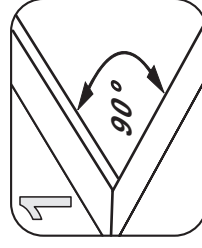
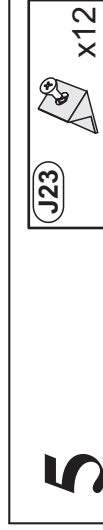
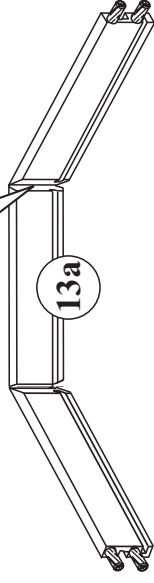
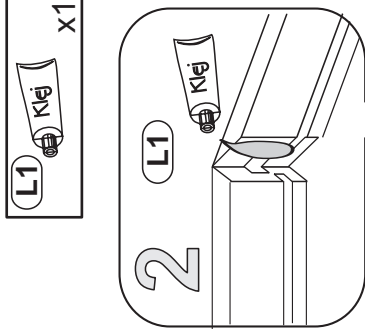
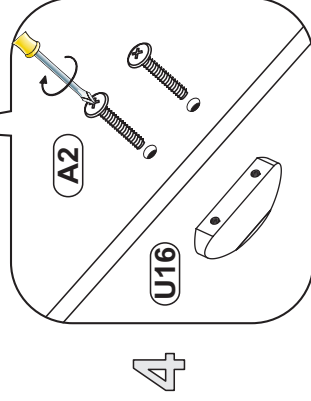
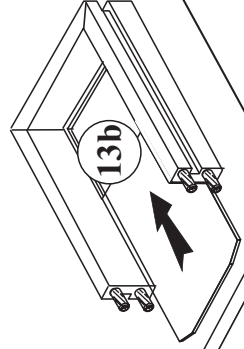
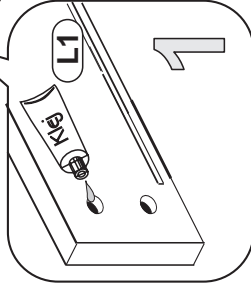
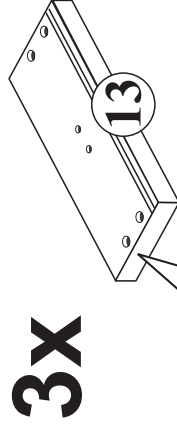
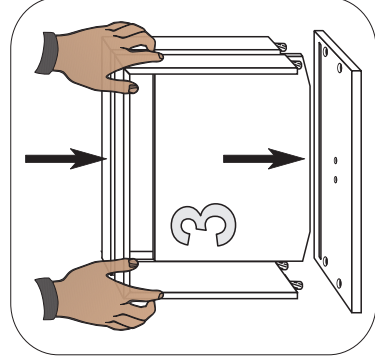
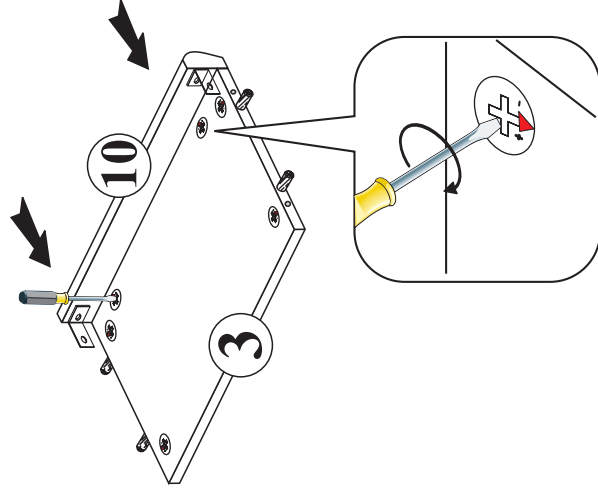
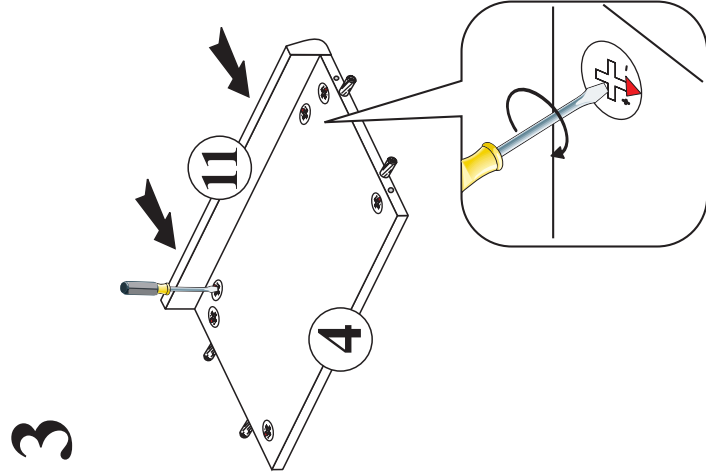
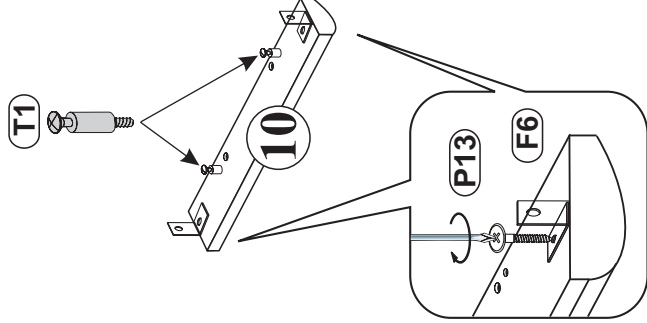
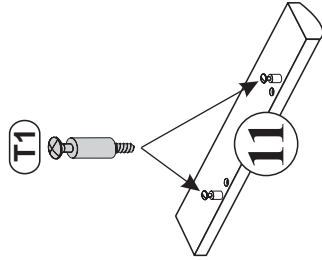
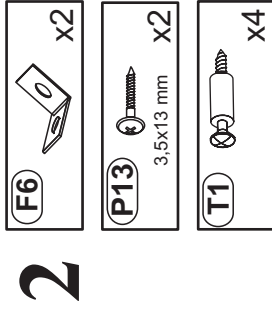

Modellname:
Nazwa modelu:

DOVER

Modellreihe:
Numer modelu:

SL -- 08

Type: **20**
Typ:

Blatt Nr **4** von: **5**
Strona z:

6

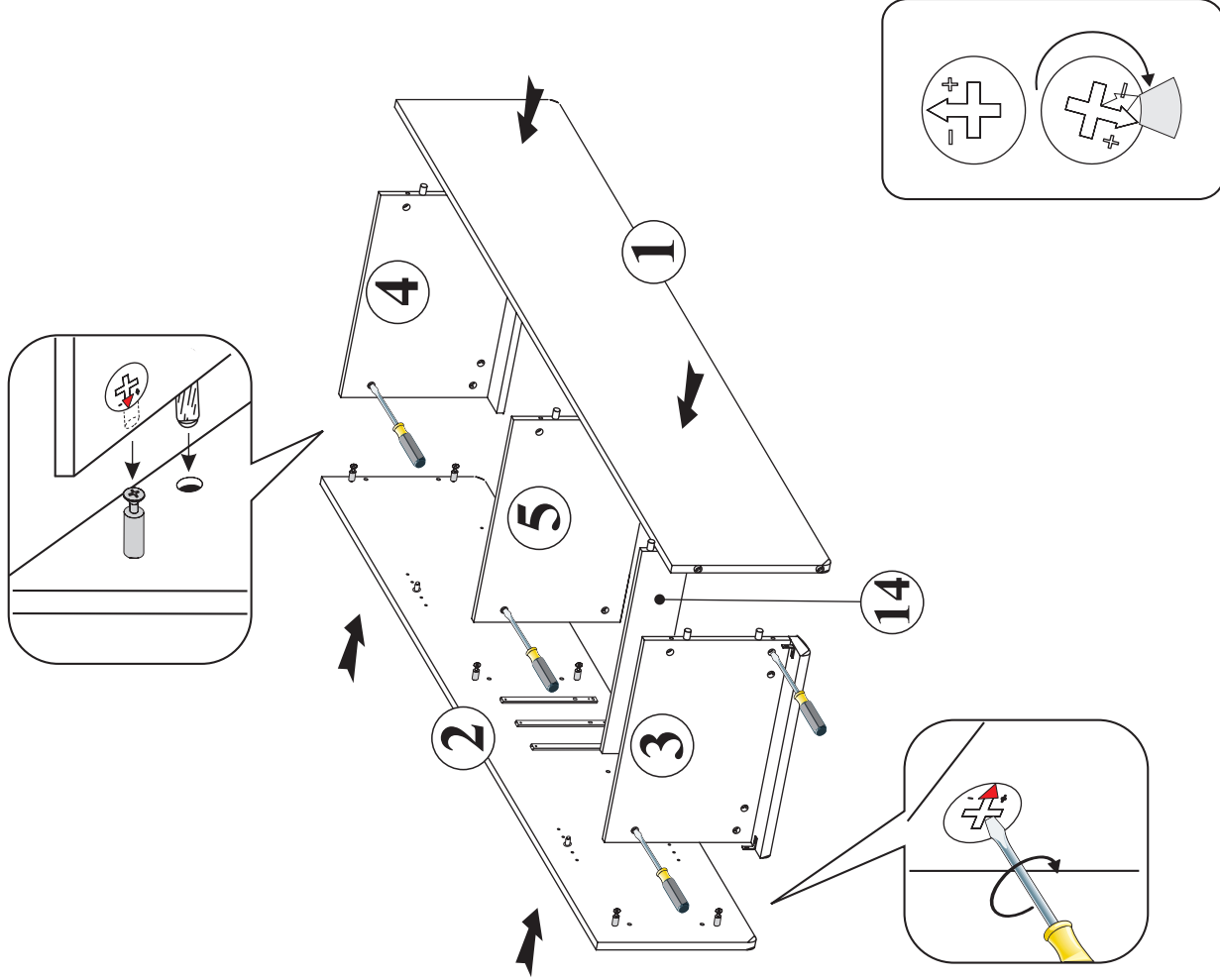

7

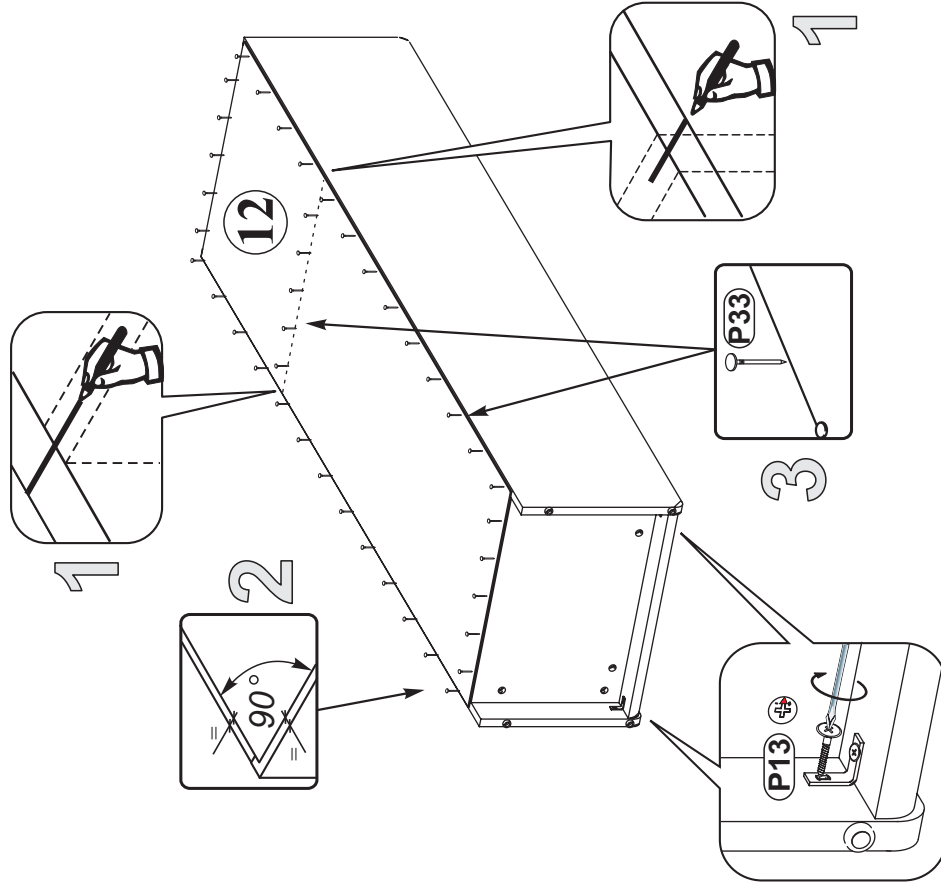

Modelname:
Nazwa modelu:

DOVER

Modellreihe:
Numer modelu:

SL -- 08

Type: **20**
Typ:

Blatt Nr **5** von: **5**
Strona z:

8

